



AIRBUS HELICOPTERS CANADA LIMITED

**FLIGHT MANUAL SUPPLEMENT  
INSTALLATION OF HIGH VISIBILITY  
FORWARD CABIN DOORS  
AS 355 N/NP**

**SUBJECT: INSTALLATION OF HIGH VISIBILITY FORWARD CABIN DOORS  
(P/N 350-202014)**

The High Visibility Forward Cabin Doors provide the cabin occupants with an increased level of visibility when compared to the standard AS 355 forward cabin doors.

**APPLICABILITY:**

This Flight Manual Supplement must be used when the High Visibility Forward Cabin Doors is installed on the helicopter.

Department of Transport  
(Canada) Approved

**IMPORTANT NOTE**

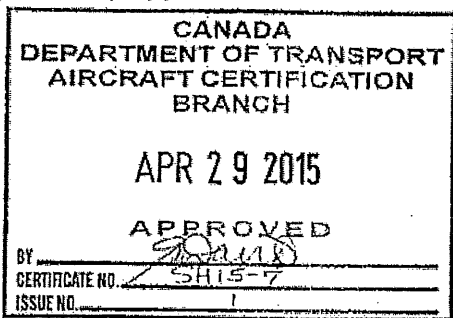

THE INFORMATION AND DATA CONTAINED IN THIS DOCUMENT SUPERSEDE OR SUPPLEMENT THAT CONTAINED IN THE BASIC APPROVED FLIGHT MANUAL FOR THE AS 355 N/NP HELICOPTER IN THOSE AREAS LISTED HEREIN. FOR LIMITATIONS, PROCEDURES AND PERFORMANCE NOT CONTAINED IN THIS DOCUMENT REFER TO THE APPROVED FLIGHT MANUAL AND OTHER APPLICABLE APPROVED FLIGHT MANUAL SUPPLEMENTS.

G. David  
Senior Engineer, Aircraft Certification  
Aircraft Certification (PAI)  
Ontario Region

SECTIONS 2, 3, 4 AND 5 OF THIS DOCUMENT COMPRISE THE APPROVED FLIGHT MANUAL SUPPLEMENT. COMPLIANCE WITH SECTION 2, LIMITATIONS, IS MANDATORY.

SECTIONS 1 AND 6 ARE UNAPPROVED AND ARE PROVIDED FOR INFORMATION ONLY.

THE INFORMATION CONTAINED IN THIS DOCUMENT SHALL BE TREATED AS THE PROPERTY OF AIRBUS HELICOPTERS CANADA LIMITED (AHCA). THE RECIPIENT OF THIS DOCUMENT SHALL NOT DISCLOSE ANY INFORMATION CONTAINED HEREIN TO THIRD PARTIES WITHOUT THE WRITTEN PERMISSION OF AHCA, AND SHALL NOT USE OR REPRODUCE THIS DOCUMENT IN WHOLE OR IN PART FOR ANY PURPOSE OTHER THAN ITS ORIGINALLY INTENDED PURPOSE, OR TO EVALUATE ITS CONTENTS.

	NAME AND SIGNATURE	DATE	COMPANY DEPARTMENT
PREPARED BY:	D. Kerr <i>DKerr</i>	17 Dec., 2014	AHCA ENGINEERING
PREPARED BY:			
CHECKED BY:	G. Krebs <i>G. Krebs</i>	Dec 17, 2014	AHCA CHIEF TEST PILOT
CHECKED BY:	C. Timmins <i>C. Timmins</i>	17 DEC, 2014	AHCA ENGINEERING
Rev. 1 ACCEPTED (Civil A/W Authority)	SEE TCCA STAMP <i>C. Timmins</i>	4 <sup>th</sup> May 2015	TCCA
Rev. 1 RELEASED BY:	P. Sharpe <i>P. Sharpe</i>	MAY 04 2015	AHCA ENGINEERING

**RECORD OF REVISIONS**

Rev.	Pages at this Revision	Description, Reason Changed Pages	Prepared (name and date)	Checked (name and date)	App'd/Acc'd (Civil A/W Authority) (name and date)	Released (name and date)
0	1 through 9	Original Issue	D. Kerr 31 October 2014	C. Timmins 31 October 2014	N/A	P. Sharpe 16 December 2014
1	1 through 9	Addition of statement in Section 2, Limitations. (Page 6)	See page 1.	See page 1.	See page 1.	See page 1.

NOTE: Revisions to this document will be distributed to operators of this equipment by the STC holder.  
 NOTE: Revised portions of affected pages are identified by a vertical black line in the margin adjacent to the change.  
 NOTE: Minor changes are released in accordance with TCCA-ACCEPTED CAR 521.154 procedures (ref. DAPM-E-0001).

**TC Approved**  
APR 29 2015

Transport Canada - Approved



AIRBUS HELICOPTERS CANADA LIMITED

FLIGHT MANUAL SUPPLEMENT  
INSTALLATION OF HIGH VISIBILITY  
FORWARD CABIN DOORS  
AS 355 N/NP

### CONTENTS

SECTION	TITLE	PAGE
1	GENERAL .....	4
2	LIMITATIONS .....	6
3	EMERGENCY PROCEDURES .....	8
4	NORMAL PROCEDURES .....	8
5	PERFORMANCE DATA .....	8
6	WEIGHT AND BALANCE .....	9

### FIGURES

FIGURE	TITLE	PAGE
1	General Layout .....	4
2	Identification labels on the LH and RH Jettison Handle Cover and Door Latches .....	7

Transport Canada - Approved

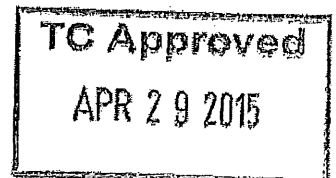

AIRBUS HELICOPTERS CANADA LIMITED

**1. GENERAL (unapproved)**

The High Visibility Forward Cabin Doors are available as an alternative to the standard AS 355 N/NP forward doors. The high visibility doors provide the cabin occupants with an increased level of visibility when compared to the standard AS 355 forward cabin doors. The doors are manufactured from composite materials and are fitted with a large one-piece window.

The doors are attached to the cabin using standard AS 355 hinges and hardware and are completely interchangeable with the standard AS 355 cabin doors. Refer to Figure 1.

The High Visibility Forward Cabin Door is offered in two variants:

- 03 - Installation LH FWD Door
- 04 - Installation RH FWD Door

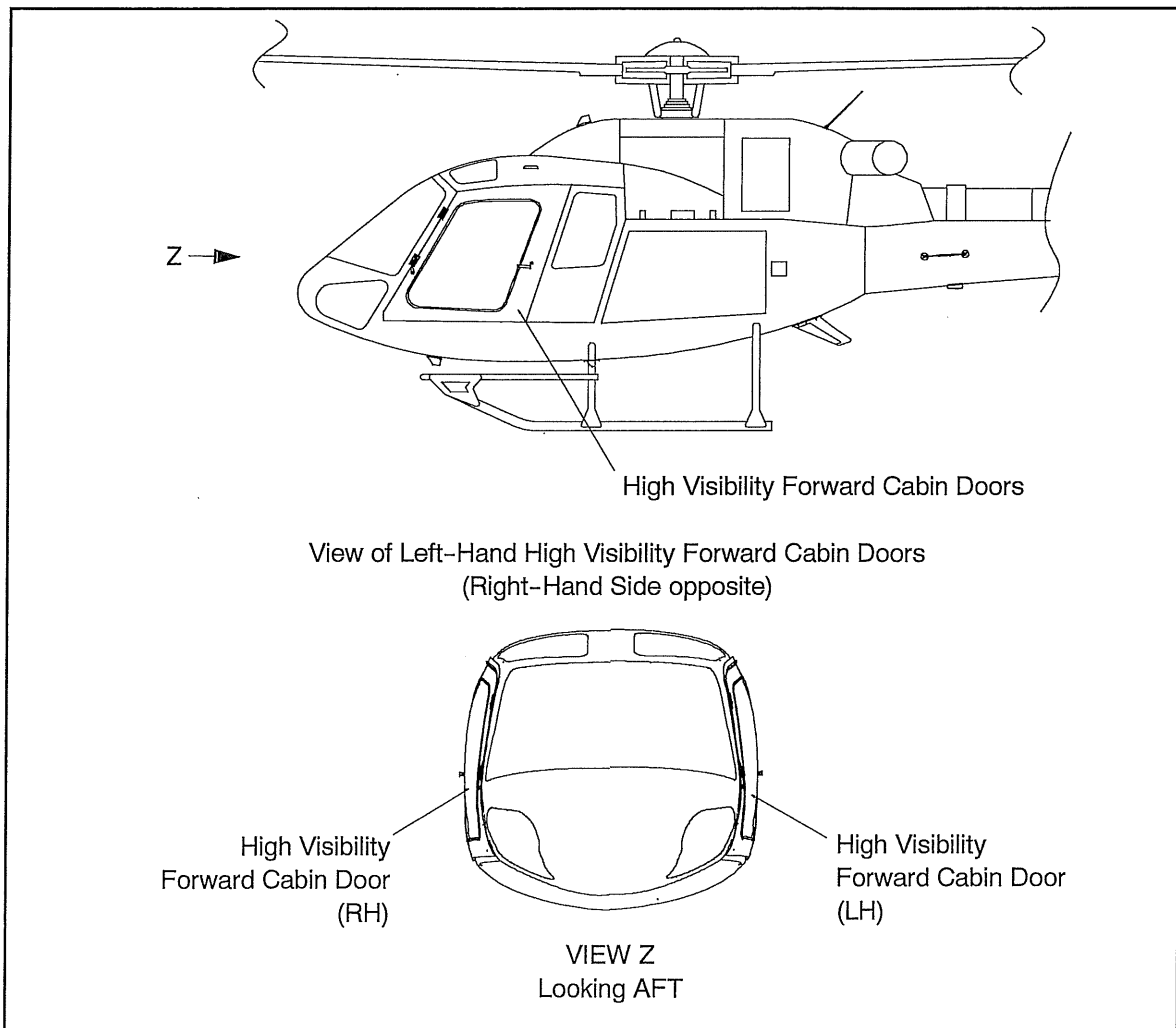

Figure 1 General Layout

Transport Canada - Unapproved

**AIRBUS HELICOPTERS CANADA LIMITED**
**1. GENERAL (unapproved) (continued)**

## Abbreviations and Definitions

ABBREVIATION	DEFINITION
Acc'd	Accepted
AH	Airbus Helicopters (France)
AHCA	Airbus Helicopters Canada Limited
App'd	Approved
A/W	Airworthiness
CAR	Canadian Aviation Regulations
DAPM	Design Approval Procedure Manual
FWD	Forward
hrs	hours
LH	Left-Hand
PAI	Aircraft Certification Division (TCCA)
P/N	Part Number
ref.	reference
Rev.	Revision
RH	Right-Hand
STC	Supplemental Type Certificate
TCCA	Transport Canada Civil Aviation

Transport Canada - Unapproved

AIRBUS HELICOPTERS CANADA LIMITED

## 2. LIMITATIONS

### a. Operation

Operation with the High Visibility Forward Cabin Doors installed is limited to day and night VFR operation only.

Operation with aft pocket doors removed is prohibited.

### b. Placards

There are two placard associated with the Installation of High Visibility Forward Cabin Doors.

1) Placard:

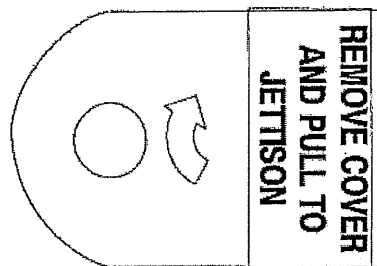

Location: Located on the LH and RH Jettison Handle Covers  
Refer to Figure 2.

2) Placard:



Location: Located on the LH and RH doors latches  
Refer to Figure 2.

Transport Canada – Approved

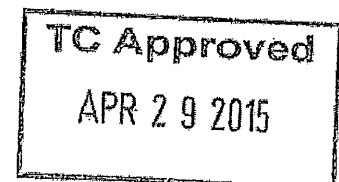

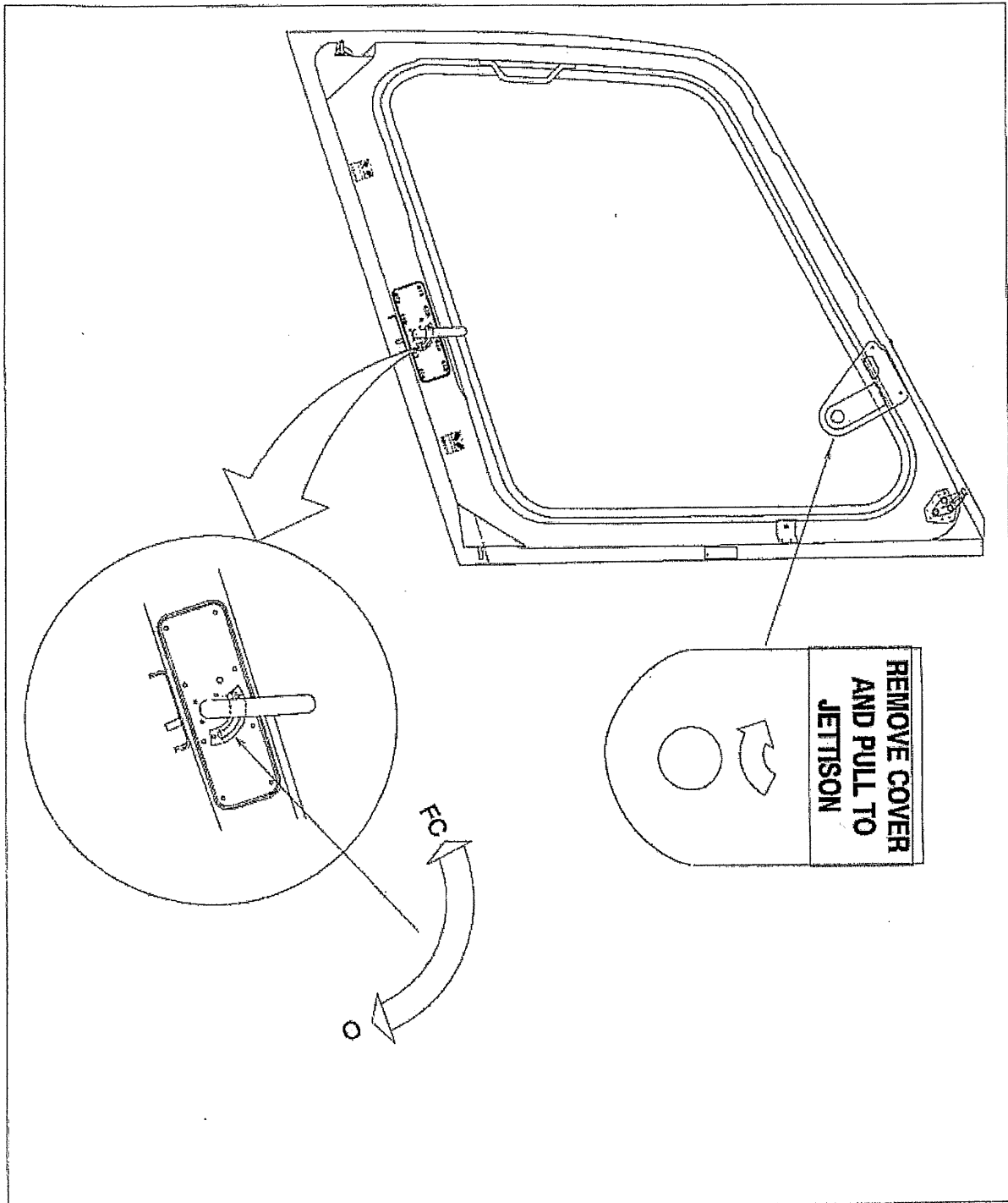

Figure 2 Identification labels on the LH and RH Jettison Handle Cover and door latches (LH shown)

Transport Canada – Approved

**TC Approved**  
APR 29 2015



**FLIGHT MANUAL SUPPLEMENT  
INSTALLATION OF HIGH VISIBILITY  
FORWARD CABIN DOORS  
AS 355 N/NP**

**AIRBUS HELICOPTERS CANADA LIMITED**

**3. EMERGENCY PROCEDURES**

Use basic Flight Manual procedures.

**4. NORMAL PROCEDURES**

Use basic Flight Manual procedures.

**5. PERFORMANCE DATA**

Use basic Flight Manual procedures.

Transport Canada - Approved

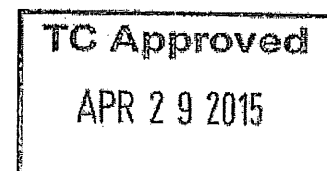



**6. WEIGHT AND BALANCE (UNAPPROVED)**

Total changes to weight and balance resulting from this modification are covered in the applicable Instructions for Continued Airworthiness.

Items that are removed between routine operations: Not applicable

Transport Canada - Unapproved